

NOTES:

1. SUBSTRATE MATERIAL:  
Fused Silica

2. COATING (APPLY ACROSS CLEAR APERTURE)

S1: Protected Gold  
R(AVG) >96% @ 700 - 2000nm  
R(AVG) >96% @ 2000 - 10,000nm

S2: NONE

3. FINE GROUND SURFACE

4. PARALLELISM: 30 ARCSEC

5. RoHS COMPLIANT

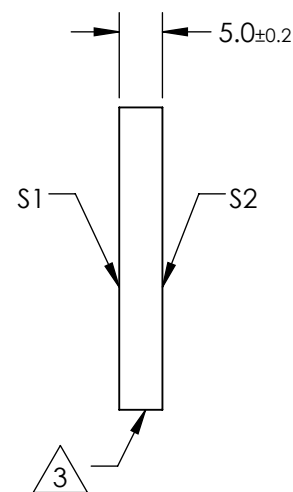
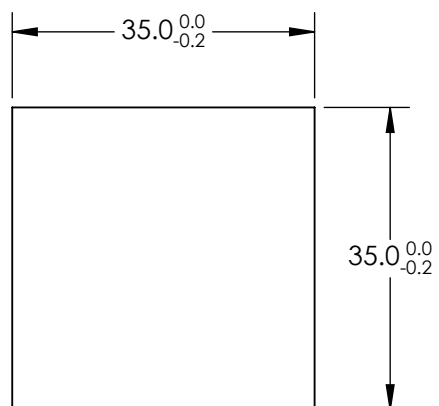

**FOR INFORMATION ONLY:  
DO NOT MANUFACTURE  
PARTS TO THIS DRAWING**

SPECIFICATIONS SUBJECT TO CHANGE WITHOUT NOTICE  
DIMENSIONS ARE FOR REFERENCE ONLY

REV. A	S1	S2
SHAPE	PLANO	PLANO
SURFACE QUALITY	20-10	N/A
SURFACE FLATNESS	$\lambda/10$	COMMERICAL POLISH
CLEAR APERTURE	90%	N/A
BEVEL	PROTECTIVE AS NEEDED	PROTECTIVE AS NEEDED

THIRD ANGLE PROJECTION

ALL DIMS IN mm

Edmund Optics®

TITLE 35mm Square Protected Gold Coated,  $\lambda/10$  Mirror

DWG NO 84434 SHEET 1 OF 1