

NOTES:

- 1. SUBSTRATE:
FUSED SILICA
- 2. RoHS: COMPLIANT
- 3. SURFACE S2 TO BE PARALLEL TO SURFACE S1 TO WITHIN < 5 ARCMIN
- 4. COATING (APPLY ACROSS CLEAR APERTURE)

S1 & S2: UV-AR (250-425nm)
Rabs ≤1.0% @ 250 - 425nm Ravg ≤0.75% @ 250 - 425nm Ravg ≤0.5% @ 370 - 420nm

5. FINE GRIND SURFACE

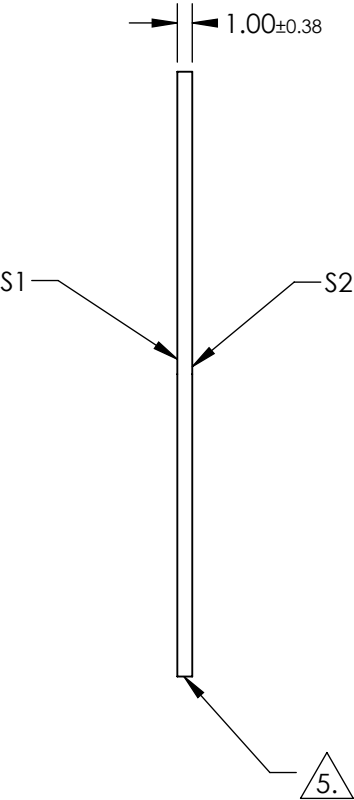
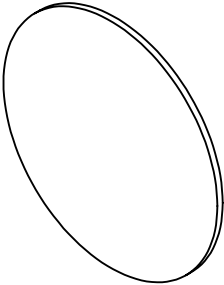
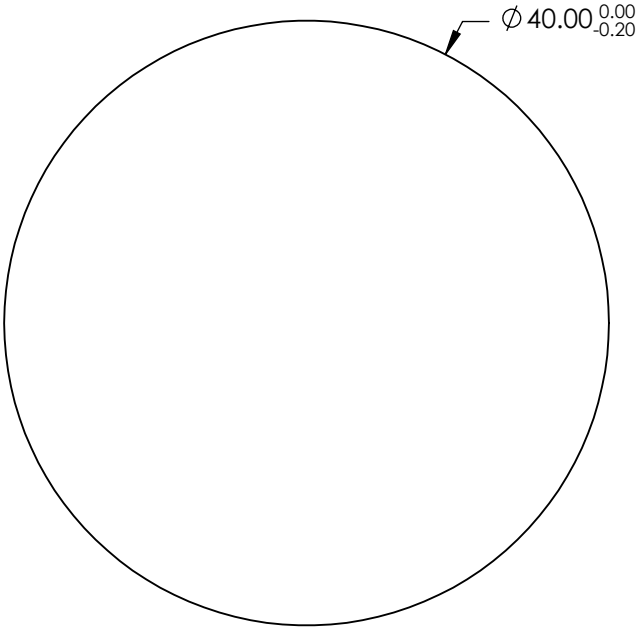

**FOR INFORMATION ONLY:
DO NOT MANUFACTURE
PARTS TO THIS DRAWING**

SPECIFICATIONS SUBJECT TO CHANGE WITHOUT NOTICE
DIMENSIONS ARE FOR REFERENCE ONLY

	S1	S2
SHAPE	PLANO	PLANO
SURFACE ACCURACY	1λ	1λ
SURFACE QUALITY	60-40	60-40
CLEAR APERTURE	Ø 36	Ø 36
BEVEL	PROTECTED AS NEEDED	PROTECTED AS NEEDED

THIRD ANGLE
PROJECTION

ALL DIMS IN mm

 **Edmund Optics®**

TITLE	40mm Dia. 1mm Thick UV-AR Coated, 1λ Fused Silica Window	
DWG NO	23330	SHEET 30 OF 35