

NOTES:

- 1. SUBSTRATE: Fused Silica
- 2. COATING (APPLY ACROSS CLEAR APERTURE)

S1&S2: Ravg ≤0.5% @ 600 - 1050nm

3. ARROW POINTS TOWARD TILTED SURFACE

4. FINE GRIND SURFACE

5. POWER, IRREGULARITY, AND SURFACE QUALITY SPECIFICATIONS APPLY ACROSS CLEAR APERTURE

6. ROHS COMPLIANT

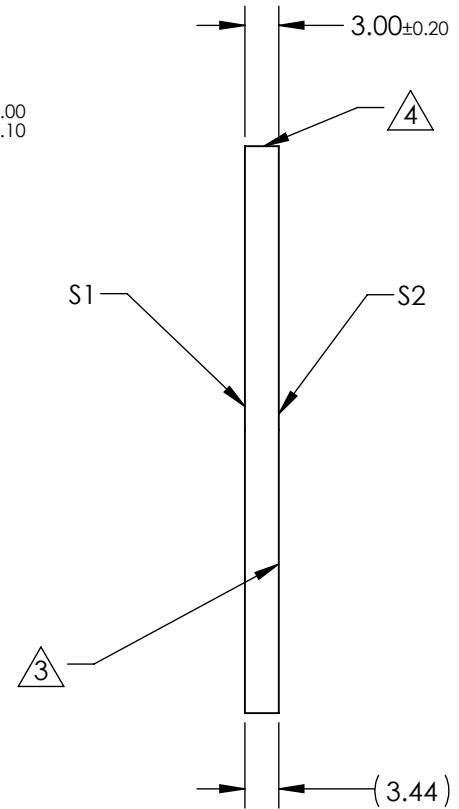
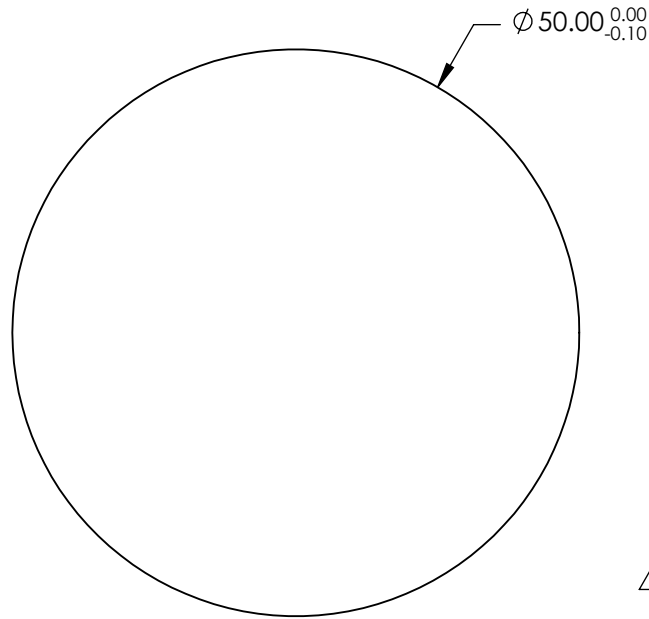
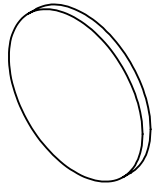

**FOR INFORMATION ONLY:  
DO NOT MANUFACTURE  
PARTS TO THIS DRAWING**

SPECIFICATIONS SUBJECT TO CHANGE WITHOUT NOTICE  
DIMENSIONS ARE FOR REFERENCE ONLY

|                     | S1                  | S2                  |
|---------------------|---------------------|---------------------|
| SHAPE               | PLANO               | PLANO               |
| RADIUS              | INFINITY            | INFINITY            |
| MINI CLEAR APERTURE | ∅ 45.00             | ∅ 45.00             |
| SURFACE QUALITY     | 20-10               | 20-10               |
| SURFACE ACCURACY    | λ/10                | λ/10                |
| BEVEL               | PROTECTED AS NEEDED | PROTECTED AS NEEDED |

THIRD ANGLE PROJECTION

ALL DIMS IN mm

Edmund Optics®

TITLE

50mm Dia., NIR I Coated, 30' Wedge, Fused Silica Wedged Window

DWG NO

25620

SHEET 6 OF 15