

NOTES:

1. SUBSTRATE:  
FUSED SILICA (CORNING 7980)
2. S1 TO BE PARALLEL WITH S2 TO WITHIN <1 ARCMIN
3. COATING (APPLY ACROSS CLEAR APERTURE)  
S1 & S2: NIR I (600-1050nm)  
R(AVG) ≤0.5% @ 600 - 1050nm

4. FINE GRIND SURFACE

5. ROHS COMPLIANT

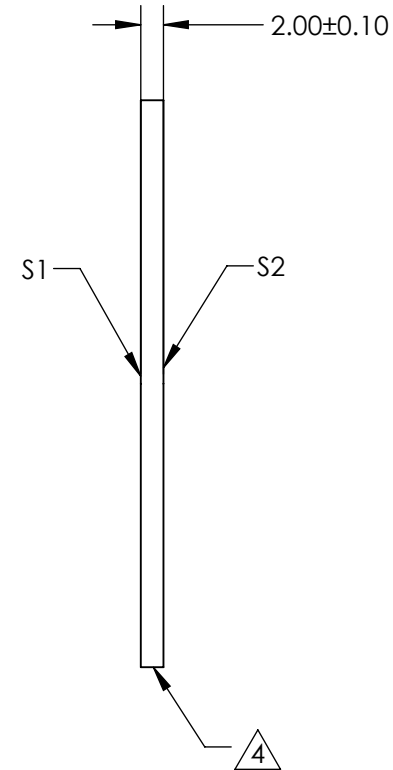
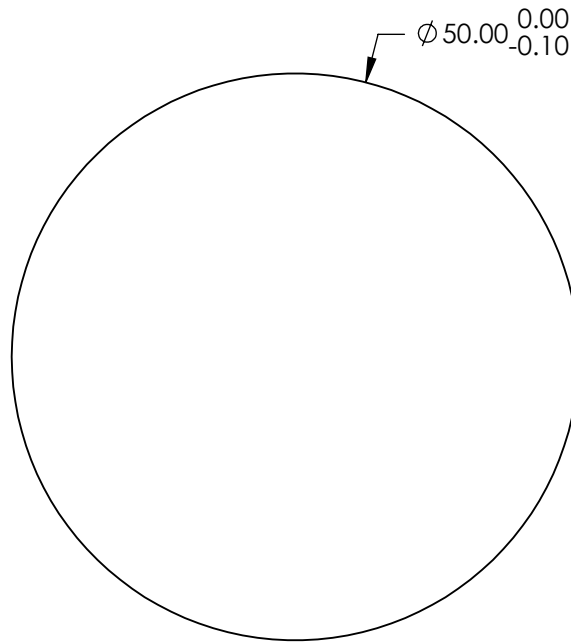
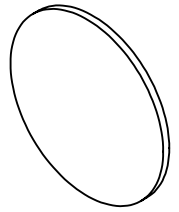

**FOR INFORMATION ONLY:  
DO NOT MANUFACTURE  
PARTS TO THIS DRAWING**

SPECIFICATIONS SUBJECT TO CHANGE WITHOUT NOTICE  
DIMENSIONS ARE FOR REFERENCE ONLY

	S1	S2
SHAPE	PLANO	PLANO
SURFACE QUALITY	40 - 20	40 - 20
CLEAR APERTURE	$\phi 45.00$	$\phi 45.00$
BEVEL	PROTECTED AS NEEDED	PROTECTED AS NEEDED

THIRD ANGLE PROJECTION

ALL DIMS IN mm

Edmund Optics®

TITLE

50mm Dia., 2mm Thick, NIR I Coated,  $\lambda/4$   
Fused Silica Window

DWG NO

72410

SHEET  
70 OF 84